

Porgracia Otemon 1106

Residential

Apartment

Vacant

Fukuoka

Posted On 31-12-2020

📍 1-1-30 Otemon, Chuo Ward, Fukuoka

¥ 6,900,000

BUY

📐 Floor Area
24.15 m²

🏠 Layout
1DK

📅 Built Year
1996



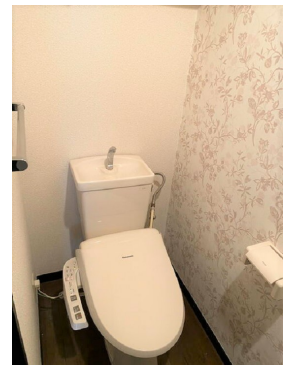
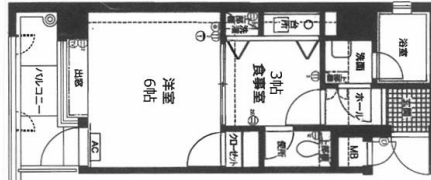

📈 Gross Yield
0%









PROPERTY INFO

Building / Land Information

| | | |
|---|---------------------|-----------------------------------|
|  | Property Name: | Porgracia Otemon 1106 |
|  | Address: | 1-1-30 Otemon, Chuo Ward, Fukuoka |
|  | Land Ownership: | Freehold |
|  | Building Structure: | Steel Reinforced Concrete |
|  | Built Year: | 1996 |

Unit Information

| | | |
|---|-----------------------|---|
|  | Layout: | 1DK |
|  | Floor / Total Floors: | 11 Floor / 13 Floors |
|  | Floor Area: | 24.15 m ² / 259.95 ft ² |
|  | Balcony Area: | 5.12 m ² / 55.11 ft ² |
|  | Occupancy Status: | Vacant |

Additional Information

| | |
|------------|---|
| Amenities: | Prime area, shopping, restaurant, hospitals, banks nearby |
| Note 1: | ID: 99036442 |

Location Information

| | | |
|---|-----------------|--|
|  | Transportation: | Akasaka station / 4 minutes walking distance |
|---|-----------------|--|

✉ info@japan-realty.com
Singapore +65 8188 8316



公众号 Page 2

INCOME & EXPENSE

| | Monthly | Annually |
|---|---------|-----------|
| Rental Income: | ¥0 | ¥0 |
| Building Management Fee: | -¥4,800 | -¥57,600 |
| Building Sinking Fund: | -¥4,800 | -¥57,600 |
| Other Miscellaneous Fee: | -¥0 | -¥0 |
| Agency Management Fee: | -¥0 | -¥0 |
| Annual Fixed Asset & City Planning Tax (Estimated): | - | -¥38,000 |
| Net Rental Income After Tax: | | ¥-153,200 |

COST OF PURCHASE

| | Offer Price | 3%↓ Offer Price | 5%↓ Offer Price |
|--|-------------|-----------------|-----------------|
| Purchase Price: | ¥6,900,000 | ¥6,693,000 | ¥6,555,000 |
| Land Registration & Legal Fee (Estimated): | ¥130,000 | | |
| Agency Brokerage Fee: | ¥293,700 | ¥286,869 | ¥282,315 |
| Total Cost of Purchase: | ¥7,323,700 | ¥7,109,869 | ¥6,967,315 |

RENTAL YIELD

| | Offer Price | 3%↓ Offer Price | 5%↓ Offer Price |
|---------------------|-------------|-----------------|-----------------|
| Purchase Price: | ¥6,900,000 | ¥6,693,000 | ¥6,555,000 |
| Gross Rental Yield: | 0.00% | 0.00% | 0.00% |
| Net Rental Yield: | -1.57% | -1.62% | -1.66% |

